

MR Breast Post-processing

XA60

2/7/2025

Close the study in View&GO by clicking **Save and Pause** before starting the following post-processing steps.



Locate the exam in the **Patient Browser**



- Confirm FS on appropriate (_W) water image for each dynamic series

Note: If DIXON swap occurs, all series will be fat saturated with the (_F) series and associated F_sub

Relabel each _W series by RT clicking & selecting **Correct**

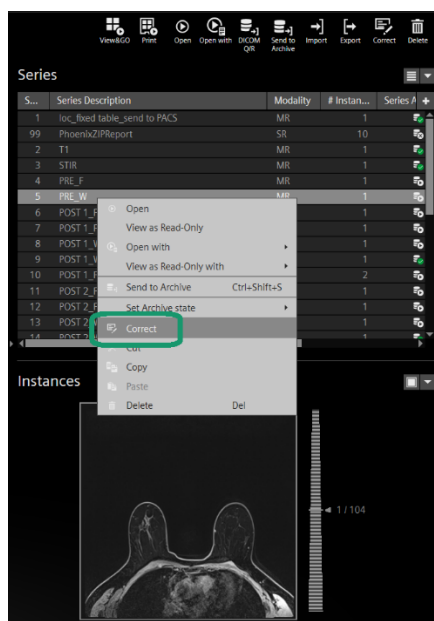

Edit the Series Description with the appropriate series name; PRE and click **OK**. Repeat this step for the remaining dynamic series: POST 1, POST 2, POST 3, POST 4, and POST 5.

Correction of Series

DOE, JANE (01/02/1959)

Patient

Study

Series

Instance

Body Part Examined

Breast

Protocol Name

PRE

Patient Position

Head First-Prone

Laterality

B

Series Description

PRE

Performing Physician

Edit

Add

Remove

Series Date and Time

2/6/2025

10:01 AM

Series Number

5

Operators' Name

Edit

Add

Remove

Institution Name

ARA CP MR3 Skyra 3T

Institution Address

W. Parmer Lane 12800, Cedar Park, Texas, US, 78613

OK

Cancel

To create the **SAG MPR** select POST 2 and send to **View&GO**

- RT click on the series and select **Parallel Ranges**
- Select **BREAST SAG 3MM** from the drop-down options
- Click **Save** and **Accept**



To create the **TIME MIP**, load each post sub dynamic into **View&GO** (POST 1_W_SUB, POST 2_W_SUB, POST 3_W_SUB, POST 4_W_SUB, and POST 5_W_SUB)

Note: If DIXON swap occurs, all series posts sub series with the (_F_SUB) will be selected.

- RT click on each series and select MIP
- Once all 5 series are MIP'd, click on **Snapshot**
- The new series will appear in the Series plane to the right. Click on the series name & relabel as TIME MIP

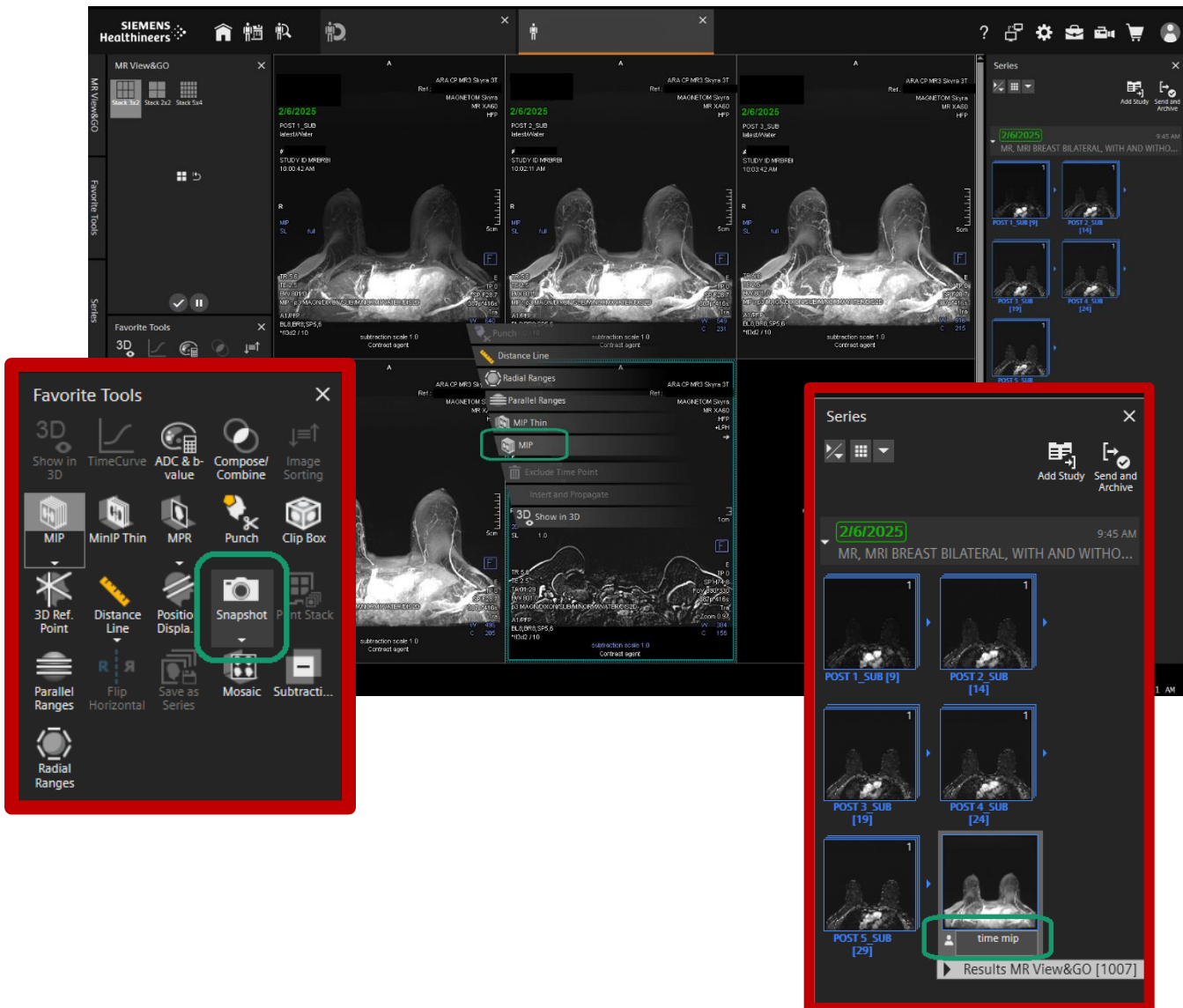

Sending to ARA BREAST CAD

- From the Patient Browser, select the appropriate series: T1, STIR, PRE, POST 1, POST 2, POST 3, POST 4, and POST 5
- Click **Export**, ensure only ARA_BREASTCAD is checked and select **Export** and **Close**

The screenshot shows the Siemens Healthineers Patient Browser interface. The 'Export Data' dialog is open, displaying a list of series to be exported. The 'Destination' dropdown is set to 'All nodes', and 'ARA_BREASTCAD' is selected. The 'Export' button is highlighted.

Export Data

Please note when exporting: patient-related information must be processed in compliance with local laws and your organization's policies.

☐ Optical Disc ☐ File System ☒ Network

Destination: All nodes

- ☒ ARA_BREASTCAD
- ☐ ARA_PACS
- ☐ ARA_PROSTATE
- ☐ CIC_AVANTO
- ☐ CLEARCANVAS
- ☐ CP_ESPREE
- ☐ CP_SKYRA2
- ☐ CPCAM
- ☐ CYBERKNIFE
- ☐ GTN_SYMTIM
- ☐ HCA_PROSTAT
- ☐ KYLE_SKYRA
- ☐ MID_AVANTO
- ☐ MPT_ESPREE
- ☐ MPT_SKYRA
- ☐ PACS_RETRIEVE
- ☐ QRY_AVANTO
- ☐ RCP_ESPREE
- ☐ RPX
- ☐ SM_SYM

511.5 MB, 8 Instances

Clear List

Export Close

Sending to ARA PACS

- From the Patient Browser, select the appropriate series: T1, STIR, PRE, POST 1, POST 2, POST 3, POST 4, POST 5 along with the subtractions, SAG MPR and TIME MIP
- Click **Send to Archive**

The screenshot displays the Siemens Healthineers Patient Browser interface. The top navigation bar includes the Siemens Healthineers logo and various icons. The main area is divided into three sections: Results, Series, and Instances. The Results section on the left shows a list of patient data. The Series section on the right displays a table of imaging series. The Instances section at the bottom right shows a large empty box for image viewing. A green box highlights the 'Send to Archive' button in the top right corner of the interface.

S...	Series Description	Modality	# Instan...	Series Archived	Expor...	Series Date
1	loc. fixed table_send to PACS	MR	1			2/6/2025 9:5
2	T1	MR	1			2/6/2025 9:5
3	STIR	MR	1			2/6/2025 9:5
4	PRE_F	MR	1			2/6/2025 10:
5	PRE	MR	1			2/6/2025 10:
6	POST 1_F	MR	1			2/6/2025 10:
7	POST 1_F_SUB	MR	1			2/6/2025 10:
8	POST 1	MR	1			2/6/2025 10:
9	POST 1_W_SUB	MR	1			2/6/2025 10:
10	POST 1_F_SUB_MIP_TRA	MR	2			2/6/2025 10:
11	POST 2_F	MR	1			2/6/2025 10:
12	POST 2_F_SUB	MR	1			2/6/2025 10:
13	POST 2	MR	1			2/6/2025 10:
14	POST 2_W_SUB	MR	1			2/6/2025 10:
15	POST 2_F_SUB_400_T0A	MR	1			2/6/2025 10: